



iJRASET

International Journal For Research in
Applied Science and Engineering Technology



INTERNATIONAL JOURNAL FOR RESEARCH

IN APPLIED SCIENCE & ENGINEERING TECHNOLOGY

Volume: 5 Issue: XI Month of publication: November 2017

DOI: <http://doi.org/10.22214/ijraset.2017.11120>

www.ijraset.com

Call:  08813907089

E-mail ID: ijraset@gmail.com

Design and Static Analysis of Homing Head Shell of Torpedo

Dr. J.V.R. Ramesh¹, K. Yogesh²

¹Mechanical Engineering Department, ²Mechanical Engineering Department

Abstract: *under water vehicles viz. torpedoes, submarines etc. are used in defence applications. These are designed for moderate to extreme depths of operation with minimum structural weight for increasing performance, speed and endurance. The present paper deals with the design and static analysis of homing head shell of a torpedo. Here various configurations of the homing head shell have been prepared and comparison study was made before finalizing the present design.*

Keywords: *Homing head, Torpedo, Shell theory, Static Analysis, self-propelled*

I. INTRODUCTION

The Torpedo is one of the oldest weapons in the Naval Inventory, having been invented over 130 years ago, But at the same time it remains one of the deadliest anti-ship and anti-submarine weapon, it is far more lethal to submarines and surface ship than any other conventional WEAPON. TORPEDO WARHEAD EXPLODES UNDER WATER, AND THAT INCREASES ITS DESTRUCTIVE EFFECT. WHEN PROJECTILE EXPLODES, THE SURROUNDING AIR ABSORBS A PART OF ITS FORCE. HOMING TORPEDOES ARE A RELATIVELY RECENT DEVELOPMENT THEY HAVE BEEN PERFECTED SINCE THE END OF WORLD WAR II. WITH HOMING TORPEDOES, A DESTROYER CAN ATTACK A SUBMERGED SUBMARINE, EVEN WHEN ITS EXACT POSITION AND DEPTH ARE UNKNOWN. THE OUTLINE OF THE TORPEDO IS SHOWN IN FIG1.

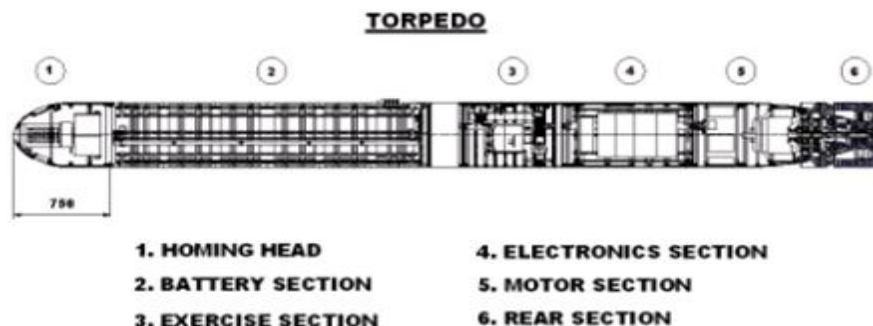

Fig: 1 Torpedo sections view

II. MATERIAL

To meet the required specifications and in view of the housing with intricate features for placing the sonar transducers, SOBID elements, echo sounder the material Chosen is Aluminium casting and the casting process should choose with the following requirements.

- A. The design has most intricate features, both external and internal. Casting helps in shaping the features with ease and as a result, many other operations, such as machining, forging and welding may be minimized or eliminated.
- B. Construction is simplified and the housing is obtained as a single piece.
- C. Machinability and vibration damping capacity is good.

With the above requirements in view aluminium alloy material with following material is selected"

TABLE I
CHEMICAL COMPOSITION (IN %BY WT)

Material	Cu	Mg	Si	Fe	Mn	Zn	Ni	Ti	Pb	Al
Chemical composition	0.1	0.2 to 0.6	6.5 to 7.5	0.5	0.3	0.1	0.1	0.1	0.1	Reminder

TABLE III
AI CASTING ALLOYS: BS1490:

Alloy	Si	Fe	Cu	Mn	Mg	Ni	Zn	Ti
LM 2	9-11.5	1.0	0.7-2.5	0.5	0.3	0.5	2.0	0.2
LM 9	9-10	2.0	0.6	0.35	0.4-0.6	0.5	0.5	
LM 24	7.5-9.5	2.0	3.0-4.0	0.5	0.1	0.5	3.0	
LM 25	6.5-7.5	0.2	0.2	0.1	0.2-0.4		0.1	0.2
LM 30	16-18	1.3	4-5	0.1	0.45-0.65		0.1	

III. DESIGN & ANALYSIS

Homing head is the fore end part of the torpedo. Its main purpose is target detection and tracking. Torpedo being a fire and forget type of weapon, comprises an intelligent homing system which has to perform an optimum search, detect target amongst decoys and eventually guide the weapon on to the target to hit it for exploding the explosive on-board. For heavy weight torpedoes the torpedo sonar has a decisive influence on the probability of the weapon system's success. The arrangements of the transducer elements and the selection of the head shape are of vital importance for the sonar design. Taking into consideration of all the requirements of the homing head, various configurations were tried out, without compromising on the functional aspects. Four configurations were worked out and they are as follows.

- A. Planar Array
- B. Conformal array
- C. Conformal Array (Inclined at an angle)
- D. Circular array

E. Design Details

The homing head is designed with the provision of circular array mapping for the transducer elements. 76 numbers of elements can be accommodated in this array. To accommodate the elements a box type structure is made as shown in the model. The shell is required to withstand the external pressure corresponding to 720m depth of operation of the torpedo. For ease of fabrication the material is chosen to be Al alloy casting as per BS: 1490. The material properties are as follows

Young's modulus E = 71000 N/m²

Density = 2700 kg/m³

Poisson's ratio = 0.32

Yield strength of the material = 280 Mpa

The cylindrical shell and the spherical shell thickness are finalized using shell theory as follows. Assuming that the shell to be thin, the thickness of the shell is calculated for the test pressure of 72 Bars.

$$S = \frac{Pd}{2t} \text{ Where,}$$

s = hoop stress

p = pressure

d = diameter of the shell

t = thickness of the shell

For thickness of 12mm, the hoop stress induced in the cylindrical portion of the shell is 160.02 Mpa and is below the allowable stress value of 191 Mpa (With factor of safety of 1.2) For spherical portion of the shell 10 mm thickness is taken, for shell without openings for SOBID imaging array, homing transducer array and echo sounder.

The transducer mounting plate is cylindrical in nature and the thickness for the mounting plate is calculated using the above thin shell formula. The thickness of 8 mm is safe for the mounting plate without any holes. As there are holes on the plate, a stress concentration factor of 3 assumed and 25mm thickness is fixed.

F. Analysis

ANSYS offers the engineers many analytic tools to solve a broad range of analysis. These tools include choices of analysis types, a large element library, nonlinear options, and material behaviour.

G. Modelling

The shell is designed using PRO-E. The solid model is transferred to ANSYS to carry out the analysis. The following fig shows the solid model of the shell.

The divergent opening at the top is for SOBID imaging array for transmission. In the middle the mounting plate is for the homing transducer array (conformal mapping). Below the homing transducer array, there is horizontal opening for the SOBID imaging array for reception. And at the bottom of the shell there is a circular opening for the echo sounder.

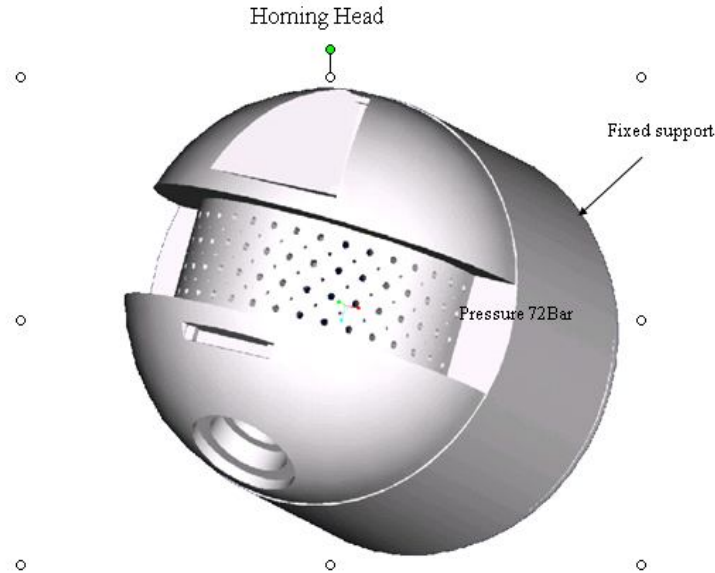

Fig:2 Torpedo sections vi Solid Model of the shell for homing head

H. Meshing

Meshing is a process use to fill the solid model with nodes and elements, i.e. to create the FEA model. 3-D shell elements are used for structures, because of geometry materials, loading or detail of required results, cannot be modelled with simpler elements 3-D solid elements are also used when the model geometry is transferred, from a 3-D CAD system. The finite element mesh obtained is shown in the following fig.

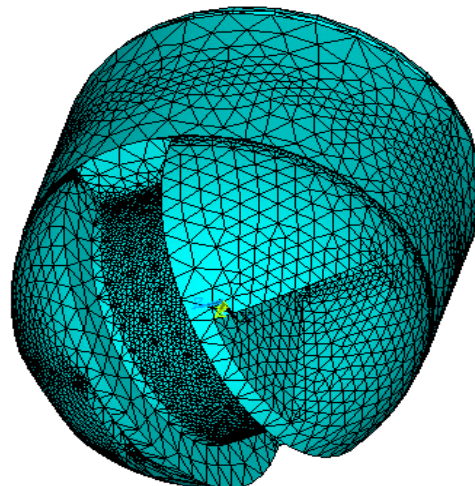

Fig:3 The Finite Element Mesh

IV. STATIC ANALYSIS

The following plot shows the von-misses stress values on the model. The maximum stress is 458.408Mpa, but this has no meaning as this is seen on a support region. Except the value at singularity the maximum stress is observed near the circumference of the homing transducer pocket opening and is equal to 152.803Mpa. The stress value is in the range of 160Mpa, which is in agreement with the theoretical value calculated

Element SHELL 93
 Density 2.7×10^9
 Poison's ratio 0.32
 Young's Modulus 71000 MPa

Loads:

An external pressure of 72 bar is applied on the outer shell

Boundary conditions

$U_x=U_y=U_z=0$ at $Y=0$

Axis of the shell - Y axis

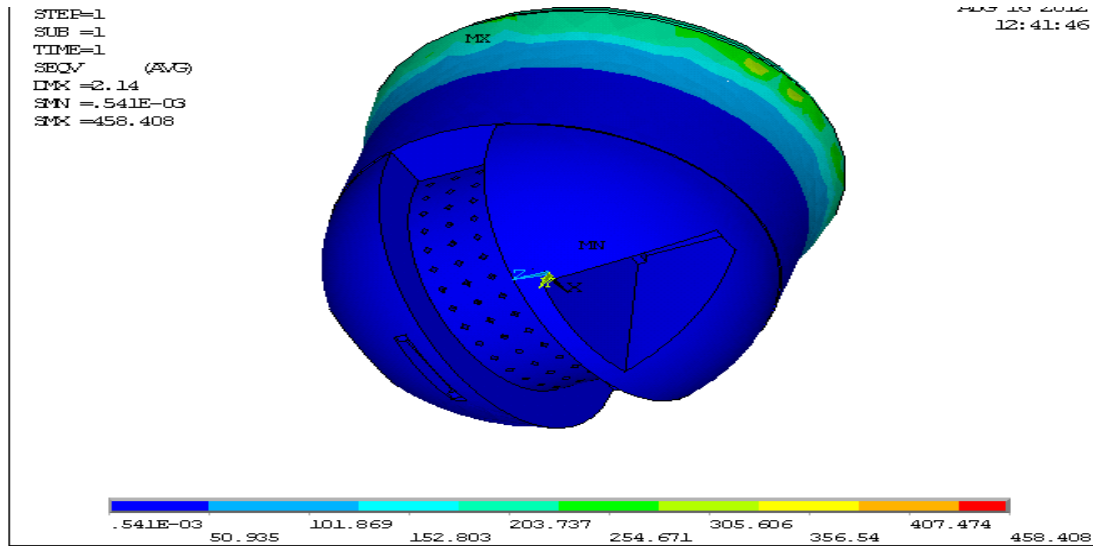

Fig: 4 von-mises stress of static analysis

Theoretical stress 160.02N/mm²
 FEM Result stress 152.803N/mm².

V. RESULTS & CONCLUSIONS

The Homing head shell was designed to the required specifications of the user group. The design is analysed for static loads and satisfied with the requirements.

REFERENCES

- [1] British Standards 5500 specifications for unfired fusion welded pressure vessels British standards institutions, April1985.
- [2] Ross C.T.F -Pressure vessels under external pressure, statics and dynamics; Elsevier applied science publishers, 1990.
- [3] Theory of thin shells by Harvey, CBS publishers.
- [4] Theory of shells-edited by W.T.Koiter and G.K.Mikhailov.
- [5] Vibrations of shells and plates (second edition, revised and expanded) Werner sude.
- [6] (Cylindrical shell buckling: A characterization of localization and periodicity discrete and continuous -G.W.Hunt, G.J.Lord Discrete and continuous dynamical systems-series Vol3 Nov4, Nov2003



10.22214/IJRASET



45.98



IMPACT FACTOR:
7.129



IMPACT FACTOR:
7.429



INTERNATIONAL JOURNAL FOR RESEARCH

IN APPLIED SCIENCE & ENGINEERING TECHNOLOGY

Call : 08813907089  (24*7 Support on Whatsapp)