



IJRASET

International Journal For Research in
Applied Science and Engineering Technology



INTERNATIONAL JOURNAL FOR RESEARCH

IN APPLIED SCIENCE & ENGINEERING TECHNOLOGY

Volume: 5 Issue: VI Month of publication: June 2017

DOI:

www.ijraset.com

Call:  08813907089

E-mail ID: ijraset@gmail.com

Analysis of Building with and without Shear Wall

Bharat Sharan Shrivastava¹, Asst. Prof. Rashmi Singh²

¹Student M.Tech Civil Engineering, Amity University Madhya Pradesh

²Asst. Prof. Department of Civil Engineering, Amity University Madhya Pradesh

Abstract - In seismic design building there are various methods to ensure stability against lateral forces caused by earthquake. Most commonly used systems is shear wall. The reinforcement concrete shear wall is one of the most reliable systems to make the structure resistant against lateral forces. Shear wall imparts stiffness to the structure which minimizes the damage caused by the earthquake and provides enough strength.. In this paper four models were analyzed in which two models are with shear wall and rest of two models are with shear wall for different heights. In shear wall models, shear wall are placed at corners. All 4 models with and without shear wall were analyzed through STAAD Pro. v8i by using response spectrum method. And calculate the lateral displacement, storey drift and base shear.

Key Words- Shear wall, Lateral Displacement, Storey Drift, Base Shear, Response Spectrum, Staad Pro v8i.

I. INTRODUCTION

Reinforced concrete framed buildings are enough to resist both vertical and horizontal loads. When the buildings are more than 15-story, either beam and column size can be quite heavy work outside the big reinforcement beam column junctions, so there are lots of crowds in these joints and this place, and this is the fact, there is no contribution in these Safety of buildings at places It is difficult to work solid vibration. These practical difficulties in the shear wall of multi-storey buildings for the introduction. A structural element of a shear wall, using the side, horizontal shear, is similar to the plane of the parrot wall parallel to the shear strength. Shear wall resist the lateral or horizontal forces by truss action for short wall where shear deformation is dominant. When the lateral force resistance is provided by the combined contribution of the frame and the structural wall, it is called a dual system or a hybrid structure, the dual system can add the benefits of its constituent elements. Tensile frames, while communicating with the walls, can provide significant amounts of energy, when necessary, especially in the upper stories of a building. On the other hand, as a result of the large rigidity of the walls, good floor control can be achieved during an earthquake, and the evolution of the reservoir mechanism that consists of the pillars (i.e., soft stories) can easily be avoided.

Under the action of the lateral forces, one frame will be mainly distorted in a shear mode, where as a wall will behave like a vertical cantilever with the primary winding distortions, in this story, the story found the walls and frames shear in opposition to the shear forces. But at higher levels, opposing each other, the resistance of the lateral forces between the walls of the dual system and the frames. The way of sharing is also affected by a dynamic reaction characteristics and the development of plastic tissues during a large seismic event and it can be estimated from a different analysis. Use of Shear wall provides an efficient solution to stiffness a structural system of a building as it increases the rigidity against lateral load acting upon the building. Shear wall significantly increases the stiffness and strength of the building in the direction of its orientation. This results in marked reduction in lateral sway of the building. Generally the Shear wall transfers the load to the next element below it in the load path. It helps in reducing the side sway of the above members like roof or floor. It also prevents the floor & roof framing members from moving off their supports when they are stiffened enough and also reduces the non- structural damages.

II. METHODOLOGY

In this chapter a multistory building has been modeled and analysis with considering all loads like Dead load, Live load, Seismic Load as per IS standard and Seismic load as per IS standard.

A. Response Spectrum Method

The main objective of the response spectrum analysis is to achieve the seismic forces of the design, along with its distribution, with the distribution of different levels with the height of the building and the different side load resistance elements. This method is based on the assumption that the dynamic reaction of the structure, by considering the independent response of each natural mode of vibration and then computing the total response together. For analysis, the mass of the structure is assumed to be lumped at the floor levels and only sway displacement is permitted at each storey. Thus for planer systems, only one degree of freedom per floor

International Journal for Research in Applied Science & Engineering Technology (IJRASET)

and for three degree of dimensional analysis three degrees of freedom per floor i.e. two translation and one angle of twist around the vertical axis must be considered.

Now the design lateral force at each mode is calculated by the formula, given in CL.7.8.4.5(c), of IS 1893 (part I):2002

$$Q_{ik} = A_k \phi_{ik} P_k W_i \tag{1}$$

B. Staad Pro V8i

All models are analysed with the help of software STAAD-Pro. This comprehensive structural engineering software addresses all aspects of the Structure Engineering - model development, analysis, design, verification and visualization. It is based on the principles of "concurrent engineering", someone can make a model, verify it graphically, analyze and design, review results, sort and search data and create reports in a similar graphics-based environment. For this the main options are available from concurrent graphics environments:

- 1) STAAD-Pro Analysis and Design
- 2) STAAD-Pre Graphics Input Generation
- 3) STAAD-Post Graphical Post-Processing

III. MODELLING AND ANALYSIS IN STAAD PRO V8I

Table 1: Details of G+25 storey building without shear wall

| | |
|-----------------------|-------------|
| Typical storey height | 3 meter |
| Size of the beam | 400mm×500mm |
| Size of Column | 600mm×600mm |

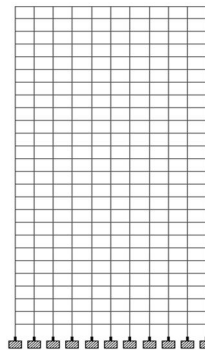

Figure 1: Plan of G+25 building

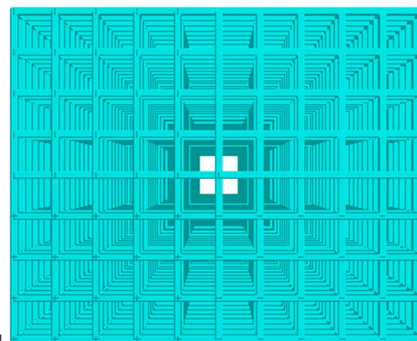

Figure 2: Top view of G+25 storey building without shear wall

Table 2: Details of G+25 storey building with shear wall

| | |
|-------------------------|-------------|
| Typical storey height | 3 meter |
| Size of the beam | 400mm×500mm |
| Size of Column | 600mm×600mm |
| Thickness of shear wall | 300mm |

International Journal for Research in Applied Science & Engineering Technology (IJRASET)

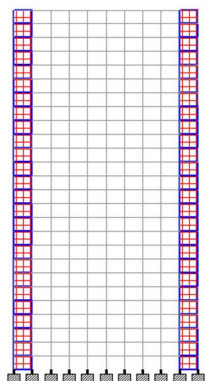

Figure 3: Plan of G+25 building

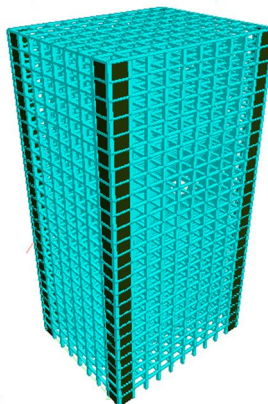

Figure 4: G+25 Building with shear wall

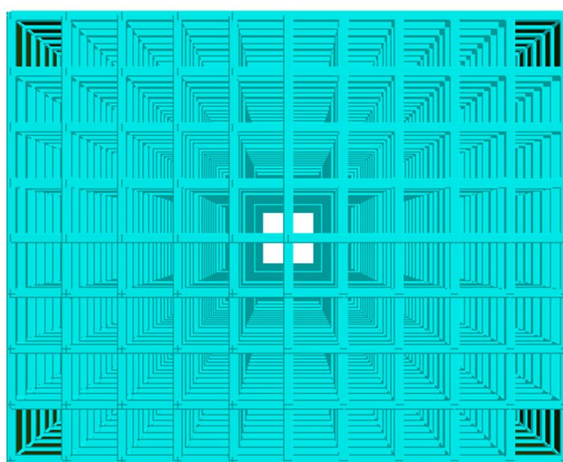

Figure.5: Top view of G+25 storey building with shear wall

Table 3: Details of G+30 storey building without shear wall

| | |
|-----------------------|-------------|
| Typical storey height | 3 meter |
| Size of the beam | 500mm×600mm |
| Size of Column | 700mm×700mm |

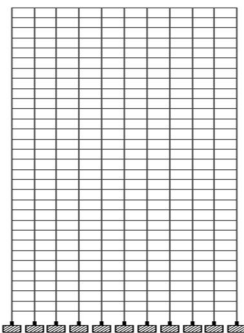

Figure 6: Plan of G+30 building

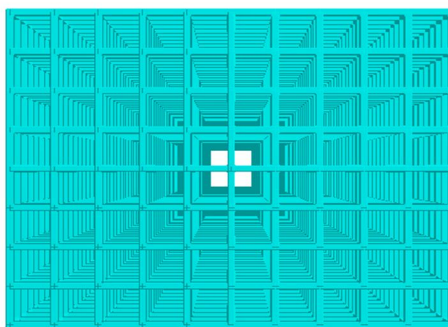

Figure 7: 3D view of G+30 building

International Journal for Research in Applied Science & Engineering Technology (IJRASET)

Table 4: Details of G+30 building with shear wall

| | |
|-------------------------|-------------|
| Typical storey height | 3 meter |
| Size of the beam | 500mm×600mm |
| Size of Column | 700mm×700mm |
| Thickness of shear wall | 300mm |

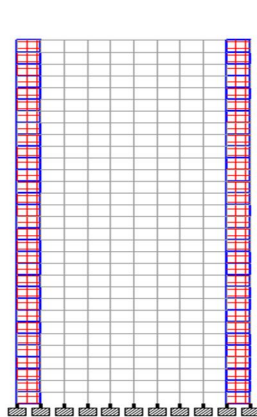

Figure 8: Plan of G+30 building

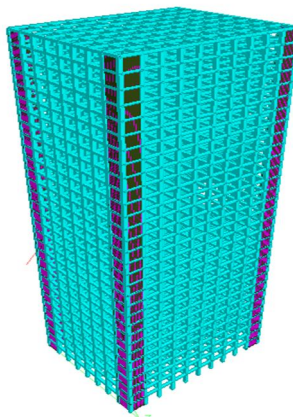

Figure 9: G+30 Building with shear wall

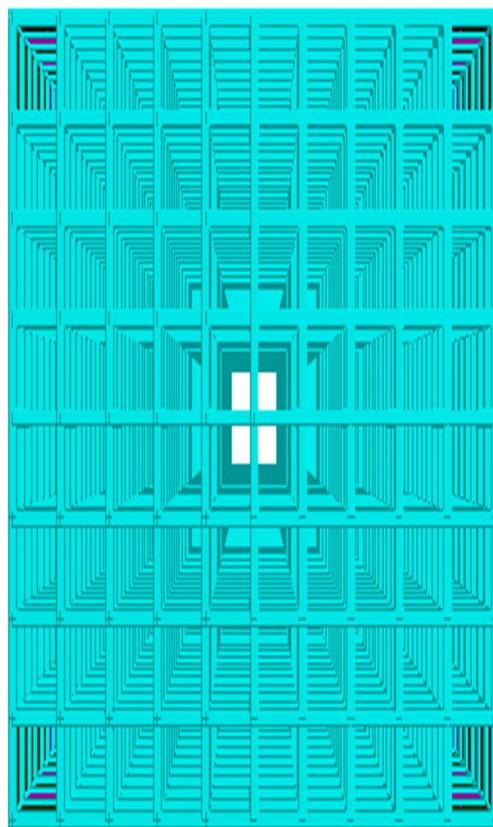

Figure 10: Top view of G+30 storey building with shear wall

International Journal for Research in Applied Science & Engineering Technology (IJRASET)

IV. RESULTS AND DISCUSSION

A. Lateral Displacement

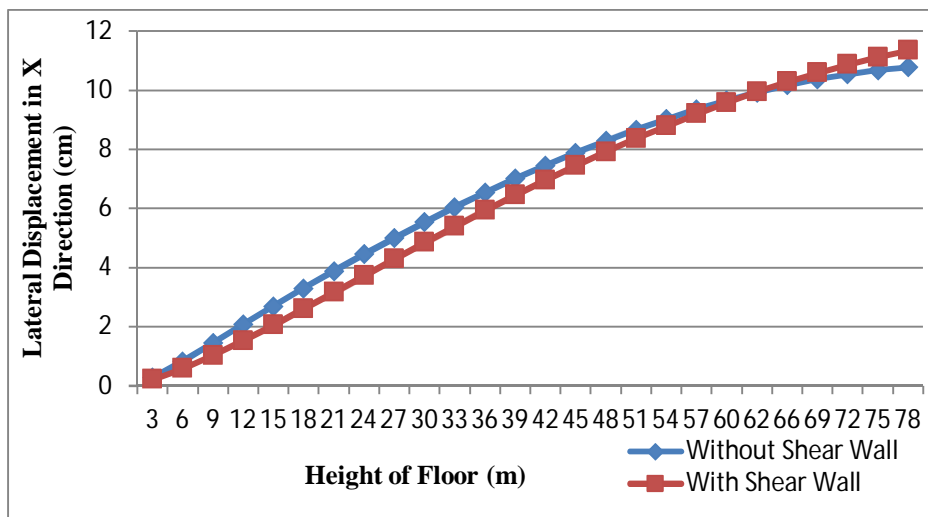

Figure 11: G+25 storey lateral displacement in X direction

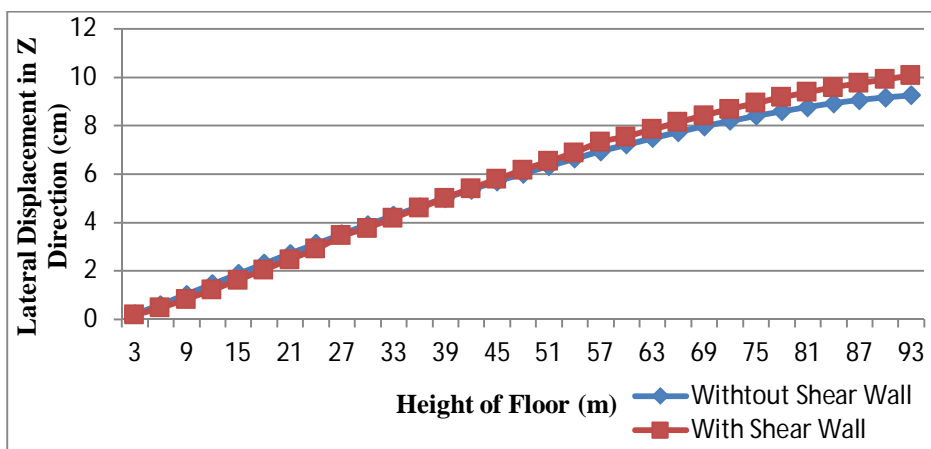

Figure 12: G+30 storey lateral displacement in X direction

B. Storey Drift

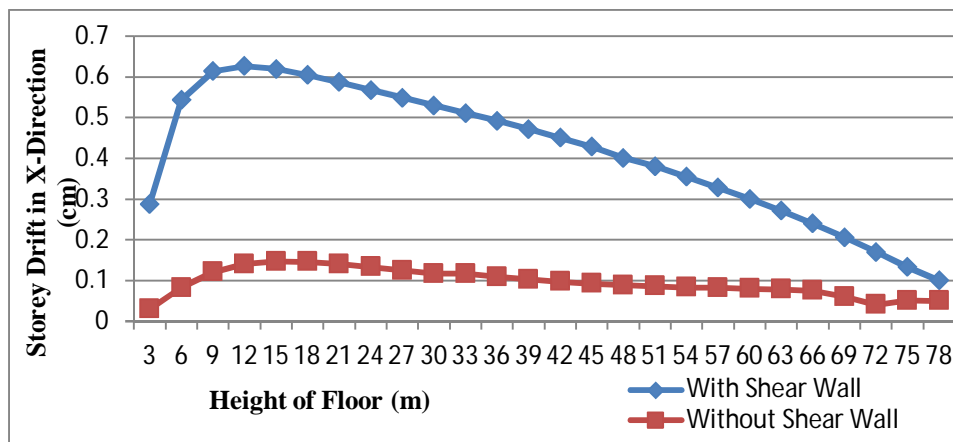

Figure 13: G+25 storey drift in X direction

International Journal for Research in Applied Science & Engineering Technology (IJRASET)

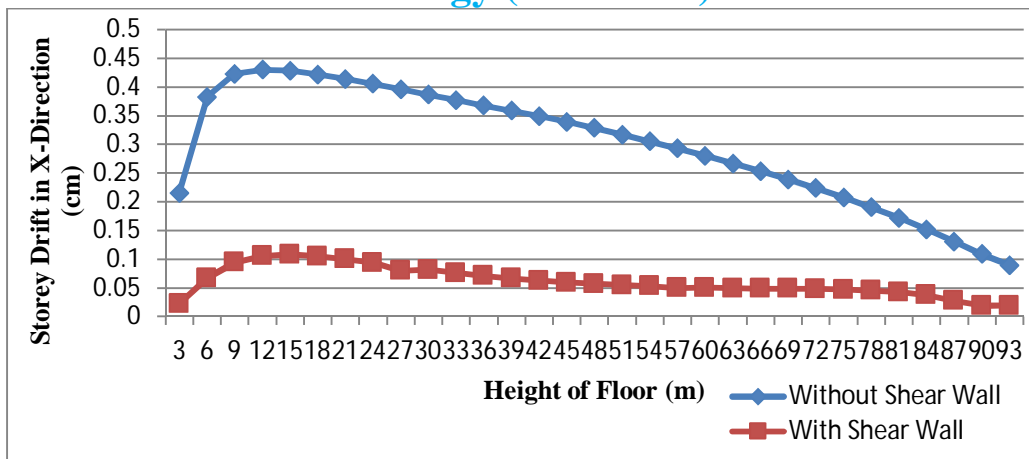

Figure 14: G+20 storey drift in X direction

C. Base Shear

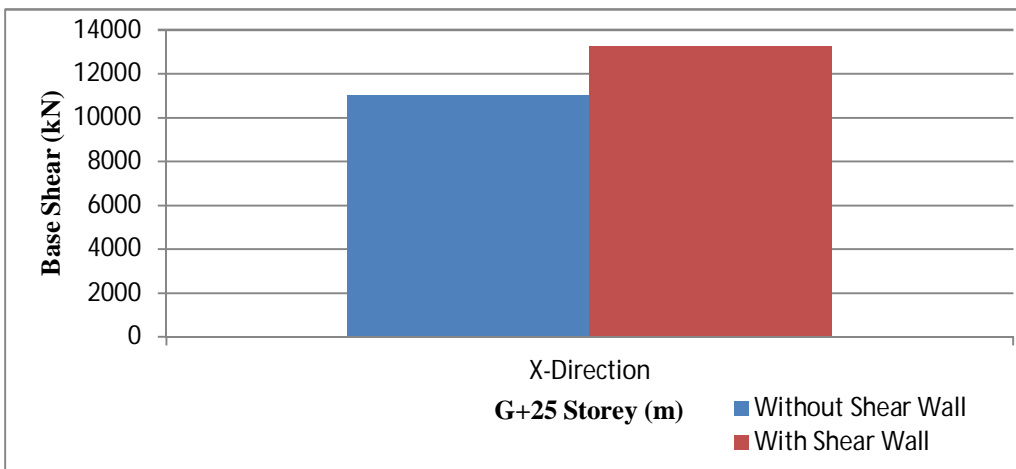

Figure 15: Base shear of G+25 storey building in X direction

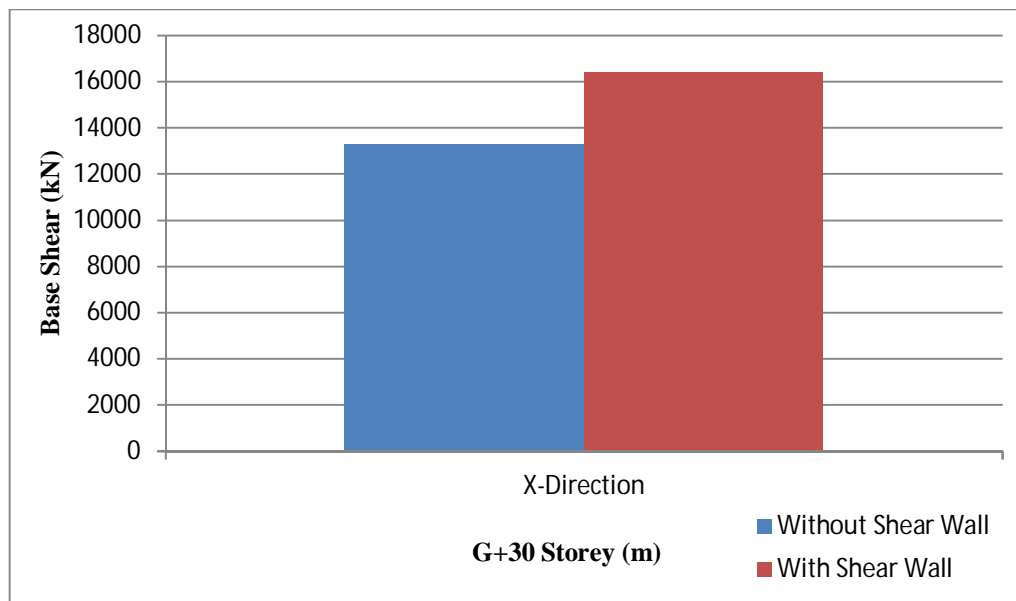

Figure 16: Base shear of G+30 storey building in X direction

International Journal for Research in Applied Science & Engineering Technology (IJRASET)

V. CONCLUSION

- A. Lateral displacement in X direction for G+25 building with the provision of shear wall is increased by 4.9% with respect to building without shear wall.
- B. Lateral displacement in X direction for G+30 building with the provision of shear wall is increased by 8.1% with respect to building without shear wall.
- C. Storey drift in X direction for G+25 building with the provision of shear wall is reduced by 50.3% with respect to building without shear wall.
- D. Storey drift in X direction for G+30 building with the provision of shear wall is reduced by 78.3% with respect to building without shear wall.
- E. Base shear in X direction for G+25 building with the provision the shear wall is increased by 16.6% with respect to building without shear wall.
- F. Base shear in X direction for G+30 building with the provision the shear wall is increased by 19.2% with respect to building without shear wall.

REFERENCES

- [1] P.Kalpna, R.D. Prasad and B. Kranthi Kumar, "Analysis of Building with and without Shear Wall at Various Heights and Variation of Zone III and Zone V", International Journal of Engineering Research and Application (IJERA). Vol.6, pp.5-11, December 2016.
- [2] Kiran Tidke, Rahul Patil and Dr. G.R. Gandhe, "Seismic Analysis of Building with and Without Shear Wall", International Journal of Innovative Research in Science, Engineering and Technology (IJRASET). Vol.3, pp.17852-17858, October 2016.
- [3] N. Venkata Sairam Kumar, R. Surendra Babu and L. Usha Kranti, "Shear walls – A review", International Journal of Innovative Research in Science, Engineering and Technology (IJRASET). Vol.3, pp.9691-9694, February 2014.
- [4] S.G. Satpute and D.B. Kulkarni, "Comparative study of reinforced concrete shear wall analysis in multi-storeyed building with openings by nonlinear methods", International Journal of Structural and Civil Engineering Research (IJSCER). Vol.2, pp. 183-193, August 2013.
- [5] Alfa Rasika and M.G. Rajendran, "Wind behaviour of buildings with and without shear wall", International Journal of Engineering Research and Applications (IJERA). Vol.3, pp.480-485, April 2013
- [6] Tarun Shrivastava, Anubhav Rai, Yogesh Kumar Bajpai, "Effectiveness of shear wall frame structural subjected to wind loading in multi storey building", International Journal of Computational Engineering Research (IJCER). Vol.5, pp.20-28, February 2015.
- [7] P.N. Pagare, P.R. Bhosale, A.P. Birar, V.D. Hayatnagar and D.C. Sawant, " Parametric Study of Building with and without Shear Walls for Seismic Performance", International Research Journal of Engineering and Technology (IRJET). Vol.3, pp 1250-1254, April 2016
- [8] IS 1893 : 2002 Indian Standard Criteria For Earthquake Resistance Design of Frame, Part 1 General Provisions And Buildings, Draft of Fifth Revision. Bureau of Indian Standards, New Delhi, 2002.
- [9] IS 13920 : 1993 Indian Standard of Reinforced Concrete Structures Subjected To Seismic Forces. Bureau of Indian Standards, New Delhi, 2003
- [10] IS 456 : 2000 Indian Standard Plain And Reinforced Concrete. Bureau of Indian Standards New Delhi, 2000.



10.22214/IJRASET



45.98



IMPACT FACTOR:
7.129



IMPACT FACTOR:
7.429



INTERNATIONAL JOURNAL FOR RESEARCH

IN APPLIED SCIENCE & ENGINEERING TECHNOLOGY

Call : 08813907089  (24*7 Support on Whatsapp)